

Fenlon 10

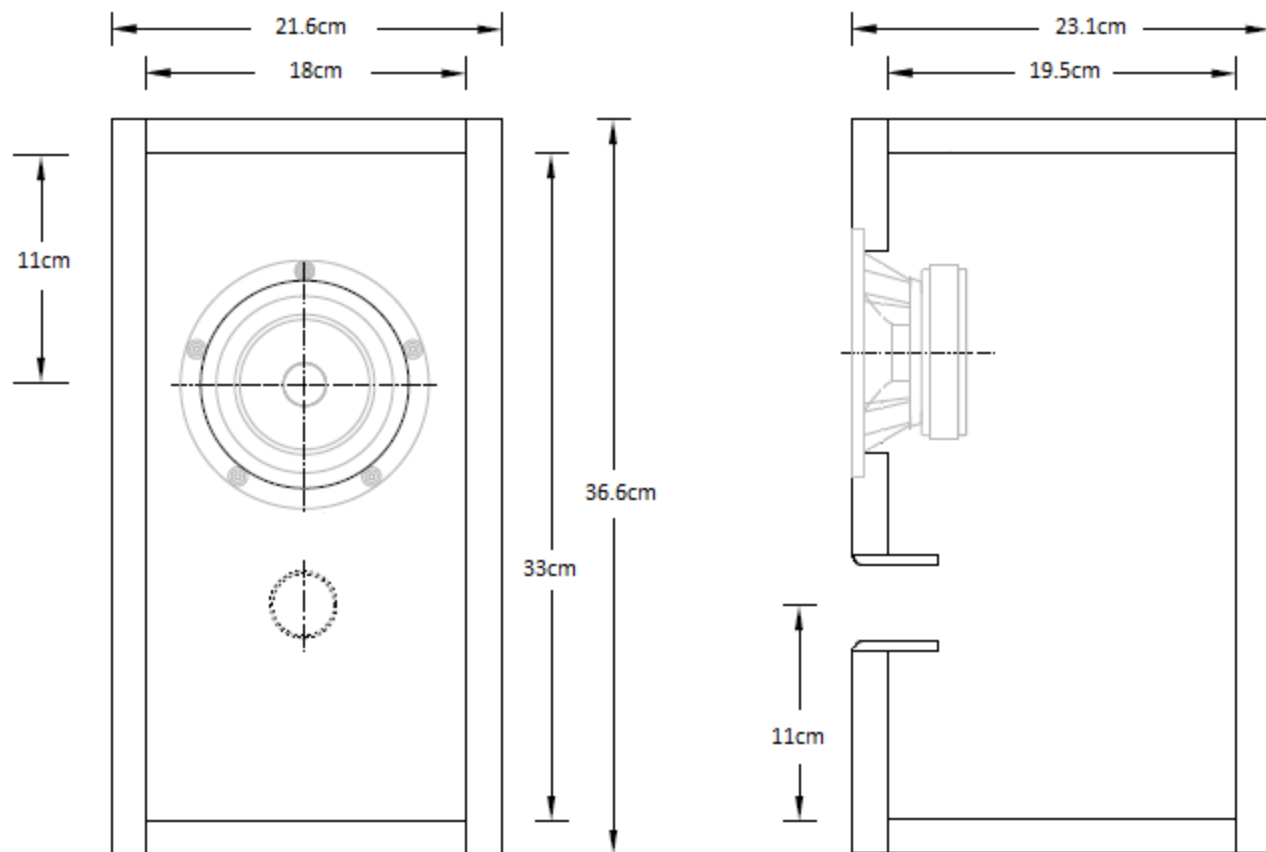

markaudio
New Audio Fidelity

- Simple vented box designed by Mark Fenlon for Alpair 10M and 10P drivers!
- Can be used with either driver! No changes needed!
- Industry norm front port!
- Projects bass forwards for interesting and captivating sound characteristic!
- Simple construction!
- Port 3cm wide and 5cm long for powerful bass performance!
- Line cabinet apart from front panel with 2cm - 3cm thick polyester damping material



Design consultant: Dr. S. Lindgren

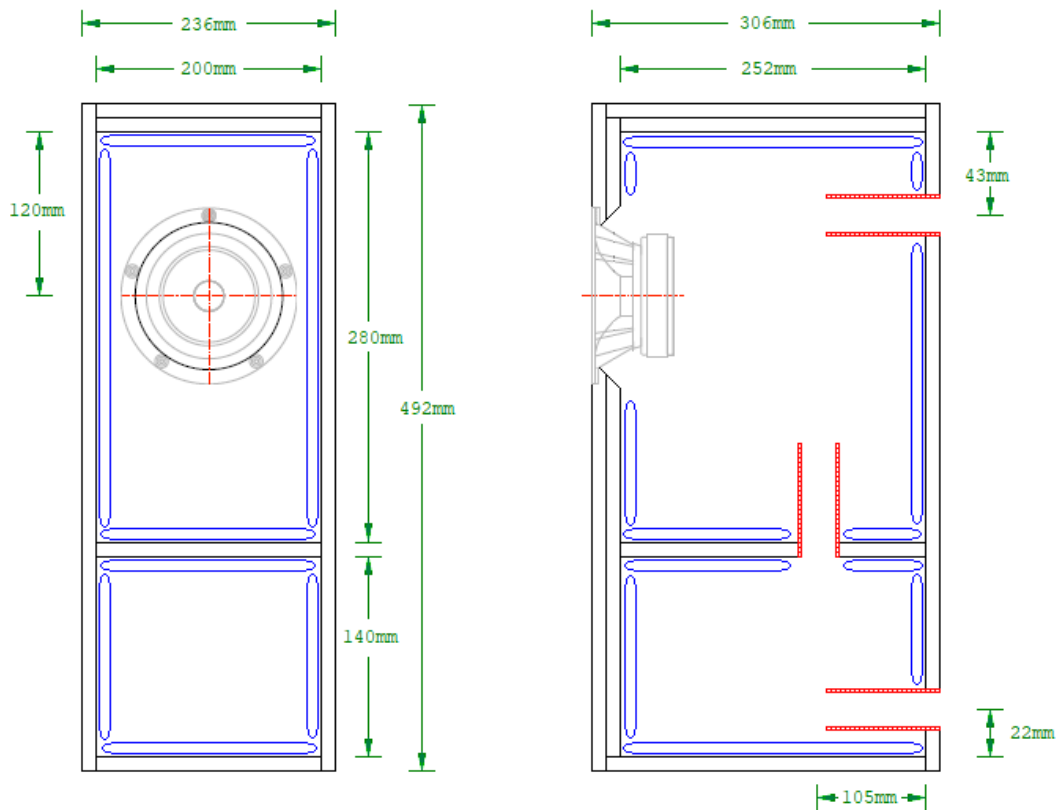

Titania
Traditional Double Chamber Reflex
 for
Markaudio Alpha 10P



Notes:

- 0/ 18mm sheet build material assumed. MDF acceptable, quality void-free multiply recommended
- 1/ Front & top baffles doubled for increased rigidity
- 2/ Bracing not shown but recommended. See Pensil 12 drawing for example of optimal longitudinal bracing
- 3/ Chamfer / relieve driver cutout to reduce reflections & enhance airflow
- 4/ All internal faces lagged 19mm OC-703 bonded acoustic fibreglass board, SAE-F10, jute or equivalent. Avoid acoustic foam

Design assumes voltage source amplifier with 1/2ohm series R for typical wire loop, connection losses

Fb = 42Hz

F6 = 38Hz [nominal anechoic]

F10 = 33Hz [nominal anechoic]

Vent options [diameter x length] for untapered ducts

- 01/ 30mm x 87mm
- 02/ 35mm x 123mm
- 03/ 36mm x 131mm

Note: to maintain correct tuning, do not mix duct diameter x length values



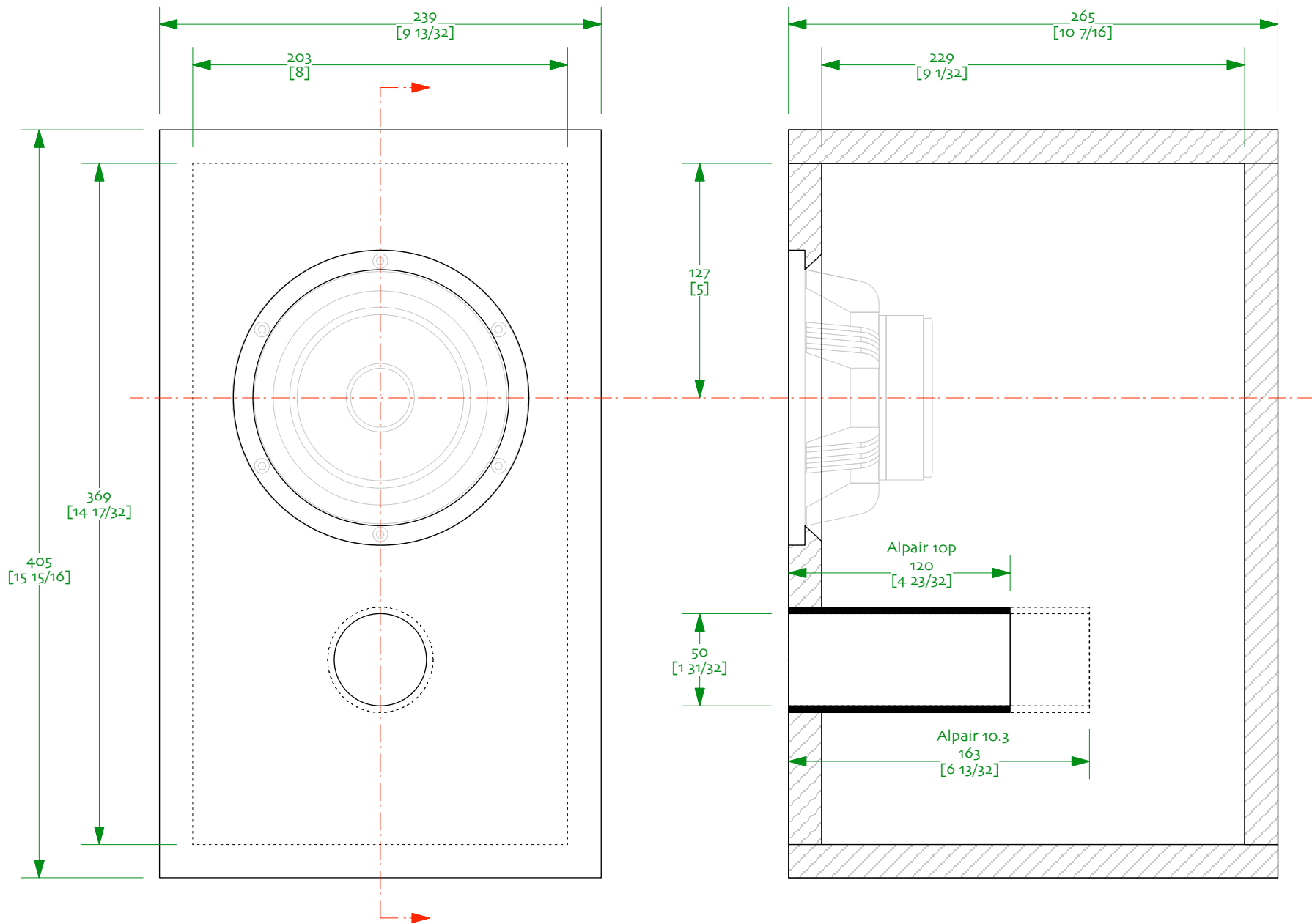

Notes

- 0/ drawn with 18 mm material
- 1/ good multi-ply recommended
- 2/ optional bracing not shown (necessary if MDF used). Orient braces vertically
- 3/ line all internal faces with damping (no egg-crate foam)
- 4/ open upback-side of driver cutout (45° bevel shown)



Simple Reflex ov9
Mark Audio Alpair 10p/10.3

Sheet 0 – 18mm plan
designed by Scott Lindgren
drawn by dld / 10-february-2014

© 2014 Woden Design | non-commercial use only

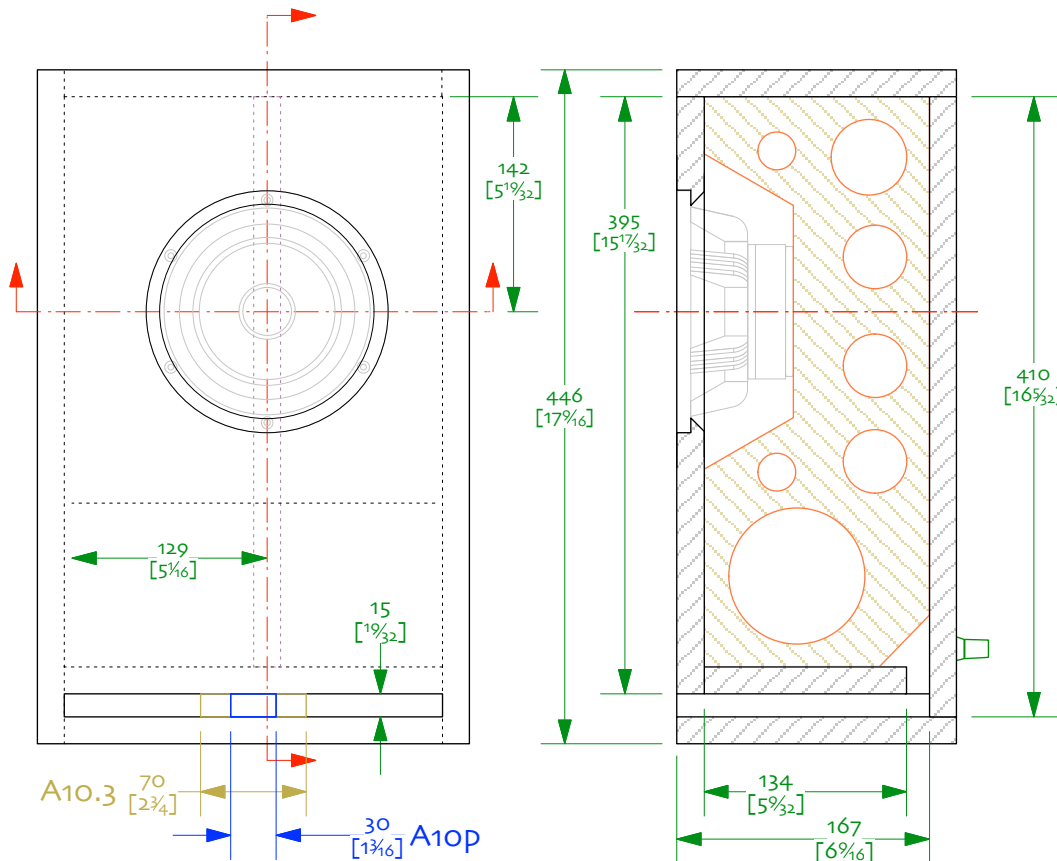
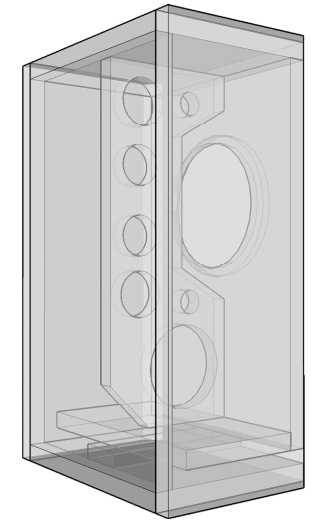
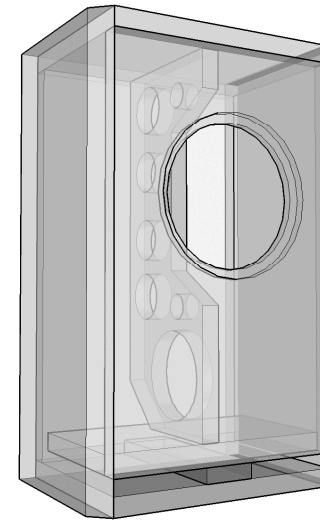
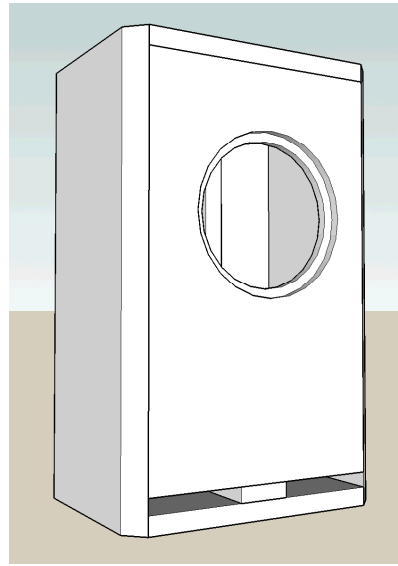
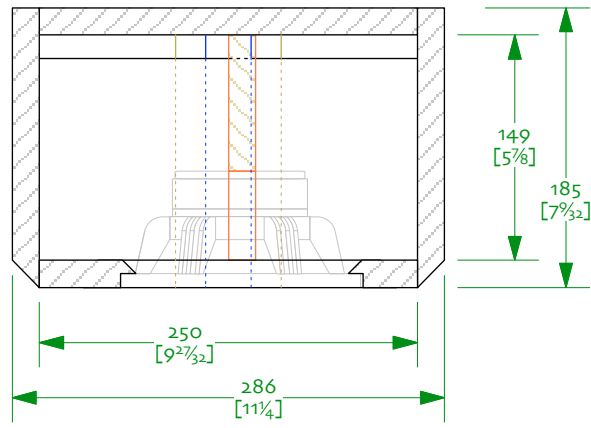

Notes:

- 0/ A classic Golden Ratio based derivative of the Mar-Ken10.3/10p designed for Mark Audio Alpair 10.3 or Alpair 10p (only change is width of vent spacer_1/ to be built as mirror imaged pairs – drivers are mounted off-centre
- 2/ All panels 18mm
- 3/ Vents are 15mm high, vent spacer is 70mm A10.3 or 30mm A10p wide and centrally located
- 4/ brace shape is only suggestive – prime purpose is to brace driver, it needs to be about 35-40% holes. (ie if you have to mount a terminal cup in the middle, you'll want to make sure the brace allows clearance), It is centrally mounted on the driver magnet
- 5/ Don't forget to angle cut the back of the driver cut-out to give it breathing room
- 6/ All internal panels lined with ~1/2" (12mm) cotton or wool felt (preferred), 3/4" (19mm) poly-fluff batting, or 1" (25mm) fiberglass Note that it is hard to get into the box after it is sealed up (means terminals need to be solderable from outside the box as well)



Classic Golden Ratio
Mar-Ken10.3 / 10p ov8

Mark Audio Alpair 10.3/Alpair 10p
© 2011-14 planet_10 enterprises limited
04-march-2014 | designed & drawn by did
free for non-commercial use only



Pensil 10.3 | Alpair 10.3

designed by S Lindgren drawn by dld
 14-june-2013 / update 30-january-2014
 ©2010-2014 Markaudio All rights reserved
 NOT for commercial use without prior
 written approval from Markimage Limited

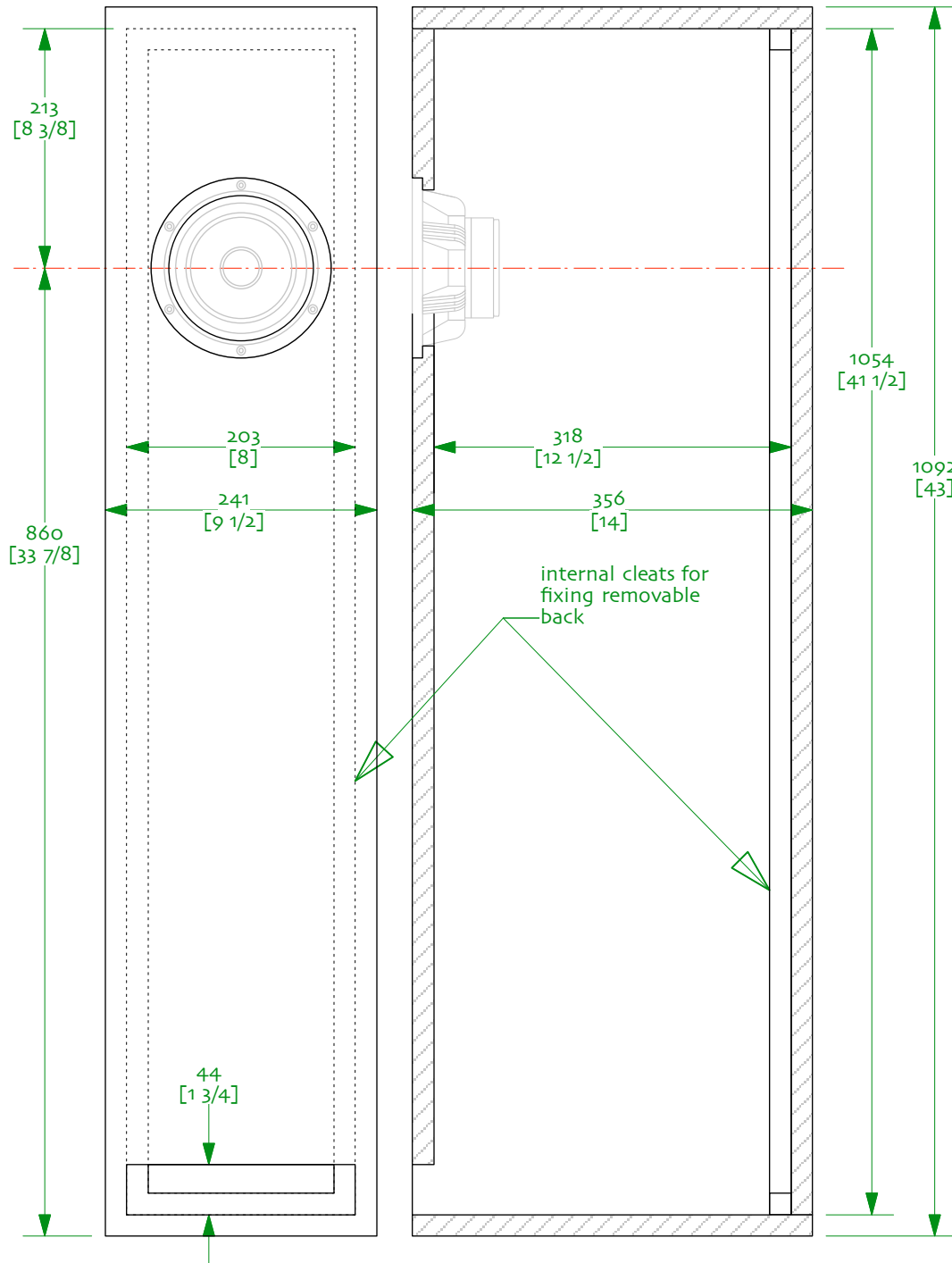

Notes:

- 0/ drawing uses 3/4" (19.1mm) material. 18-20mm OK. Quality multi-ply recommended
- 1/ stuff with 1.56 lbs / ft³ (25 ounces = 709 g) of polyfill
- 2/cleats on back to allow for removable back, useful for adjusting the stuffing
- 3/ bracing is optional. For bracing ideas please see the bracing sheet in the superPensil12 plans