

HiFi SERIE

AMT19CM1.1-C
179 €/pc

Special Properties

- High Efficiency
- Extended Bandwidth

RESISTANCE	NOMINAL 8 OHM	
Zo 8.4 OHM	• Zmin 8.2 OHM	• RE 8.1 OHM
SENSITIVITY @ 2.83 V	91 dB	
FREQUENCY RESPONSE / -6 dB	2000 Hz – 35 kHz	
POWER HANDLING	120 W	
RESONANCE FREQUENCY / FS	2300 Hz	
RECOMMENDED CROSSOVER / 6 dB	3100 Hz	
RECOMMENDED CROSSOVER / 12 dB	2800 Hz	
DISPERSION HORIZONTAL / 15 kHz / -6 dB	65°	
DIAPHRAGM AREA	1260 mm ²	
MAGNET MATERIAL	NEODYMIUM	
FACE PLATE	3 mm Anodized Aluminum	
TOTAL WEIGHT	340 g	

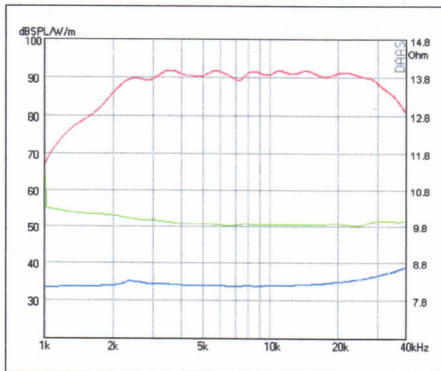

SPL 2.83 V - Phase - Impedance

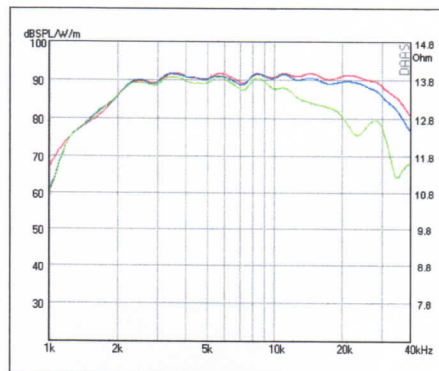

SPL HORIZONTAL 0° - 15° - 30°

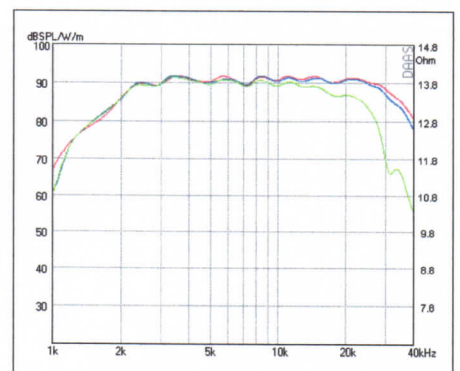

SPL VERTIKAL 0° - 5° - 15°

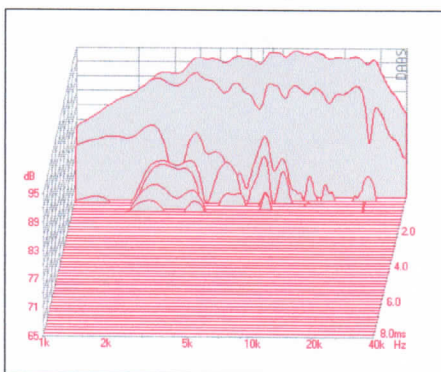

Waterfall

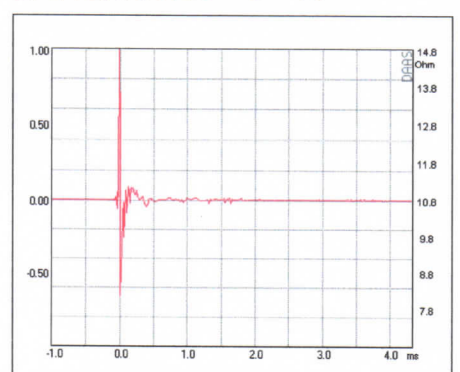
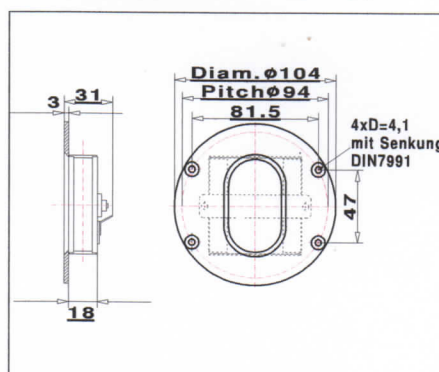

Impulse Response

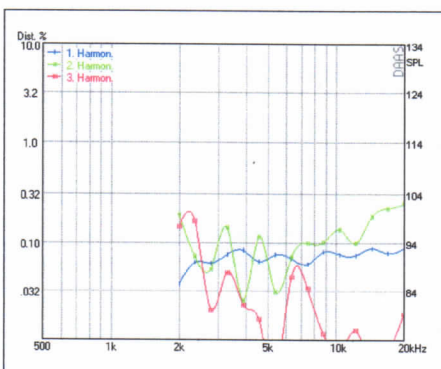

Harmonic Distortion 2.83 V

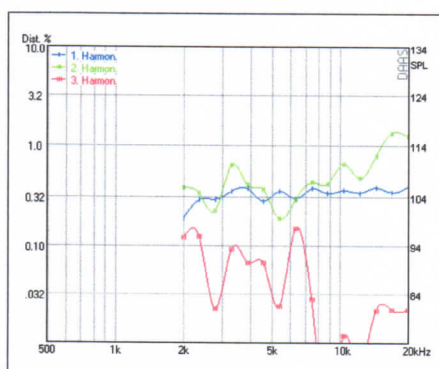

Harmonic Distortion 105 dB

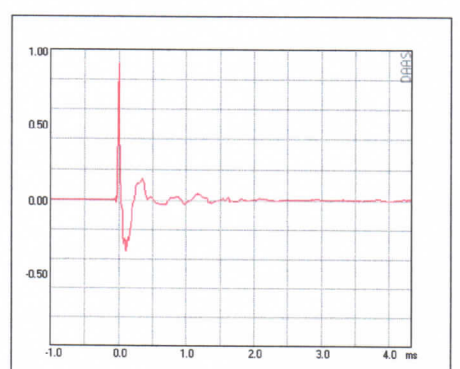

Step Response