

S.M.S.L



说明书
MANUAL

Dp5

本说明书的内容可能会随版本更改, 如有变动, 恕不另行通知

ver 1.0

Safety Notes



CAUTION

RISK OF ELECTRIC SHOCK
DO NOT OPEN



CAUTION:

TO REDUCE THE RISK OF ELECTRIC SHOCK, DO NOT REMOVE COVER (OR BACK)



The lightning flash with arrowhead symbol, within an equilateral triangle, is intended to alert the user to the presence of uninsulated “dangerous voltage” within the product’s enclosure that may be of sufficient magnitude to constitute a risk of electric shock to persons.



The exclamation point within an equilateral triangle is intended to alert the user to the presence of important operating and maintenance (servicing) instructions in the literature accompanying the appliance.



Safe use only under elevation 2000m.

Important note:

The product specifications and information mentioned in this manual are for reference only. The content of this manual is subject to change without notice.

WARNING: TO REDUCE THE RISK OF FIRE OR ELECTRIC SHOCK, DO NOT EXPOSE THIS APPLIANCE TO RAIN OR MOISTURE.

Feature

- Supports audio format of DSD , WAV , APE , FLAC , AIFF , MP3 Etc.
- Fully supports MQA decoding including local playback and USB DAC.
- Several output options: USB , coaxial , I²S , AES/EBU , Single-ended analog, balanced analog, headphone 6.35mm.
- ES9038PRO D/A Chip, Ultra-high dynamic range of 130dB, Ultra-low THD+N(0.00015%).
- Supports up to 32 bit/ 384 kHz ,DSD256 audio files.
- DOP and D2P output supported by SPDIF.
- 3.5" large size full view IPS LCD.
- Newly designed UI for better Intuitive operation.
- Supports wired and Wifi connection.Wifi format of 2.4GHz and 5GHz.
- Supports streaming playback of DLNA and Airplay.
- Bluetooth with transmitting and receiving function and supports APTX format.
- External hard-Disk connected by USB supports up to 4TB capacity ,and supports NTFS/FAT32 format.
- With USB DAC function which can play music from computer by USB jack.
- USB jack can connect other USB DAC, and output high bit rate or even DSD audio through USB.
- Built-in high-efficiency and low-noise switching mode power supply.
- With earphone monitoring function.

Note:

Firmware and driver download:

<http://www.smsl-audio.com>

Specifications

- Input mode: USBx2 / USB Audio / micro SD / Bluetooth / DLNA/ SAMBA(NAS)
- Output mode: Line / balanced / headphone / optical fiber / coaxial / AES / Bluetooth USB / USB out / I'S
- THD+N: 0.00015%
- Dynamic range: 130dB (A-Weighted)
- SNR: 130dB (A-Weighted)
- Headphone output power: 89mW(32Ω)
64mW(64Ω)
27mW(150Ω)
14mW(300Ω)
- Unbalanced line output level: 2.1Vrms
- Balanced line output level: 5.2Vrms
- USB Audio: DSD Top support DSD256
PCM Top support PCM384kHz
- USB Audio System compatibility: windows 7/8/8.1/10;Mac OS X;Linux
- DSD D2P: Transcoding 88.2kHz

Specifications are subject to change without notice.

Specifications

- DSD DOP: Top support DSD 256
- DSD Native: Top support DSD 256
- Digital outputDOP output: Top support for DSD64
- PCM: Top support 384kHz
- File system: Support FAT/FAT32/NTFS
- micro SD Capacity of card: Top support 256G
- USB drive/Hard disk: Top support 4T
- USB Maximum output current: 2A(The sum of two USB output currents)
- USB A maximum output current: 2A
- USB DAC output: Support
- Bluetooth version: 4.0 Edition
- APT-X Support
- BlueInput: Support
- Bluetooth output: Support
- HiBy Link: Support
- WIFI function: Support
- WIFI Specifications: Support 2.4G/5G
- Mesh size: 100Mb/s
- File browsing: Support
- System language: Simplified Chinese、 Traditional Chinese、 English
- Software upgrade: Support
- Power consumption: 4W
- Standby: 0.5W

Specifications are subject to change without notice.

Formats

Format	Support	Level	Sampling rate*		Bit width	CUE	Remarks
			Min	Max			
APE**	√	Fast	8K	384K	16-24bit	√	
	√	Normal	8K	384K	16-24bit	√	
	√	High	8K	384K	16-24bit		
	√	Extra high	8K	96K	16-24bit		176/192K Nonsupport
	×	Insane	8K				
WAV	√		8K	384K	16-32bit	√	DIS not support
WMA	√		8K	96K	16-24bit		
WMA Lossless	√		8K	96K	16-24bit		
Flac	√		8K	384K	16-24bit	√	
DSF	√		2.8M	11.2M	1bit		
DFF	√		2.8M	11.2M	1bit		
ISO DSD	×						
ISO DST	×						
Aiff	√		8K	384K	16-32bit		
M4A	√		8K	384K	16-24bit		
Mp2	√		8K	48K	16bit		
Mp3	√		8K	48K	16bit	√	
AAC	√		8K	48K	16bit		
OGG	√		8K	48K	16bit		

Note:

- * The mark here is the rate of sampling is not a file rate.
- ** Ape : 32-192KHz's Insane file does not support.
176.4KHz, 192KHz's Extra high file does not support.
- *** ISO8 files do not support.
- **** ALL 64K files do not support.

Remote control

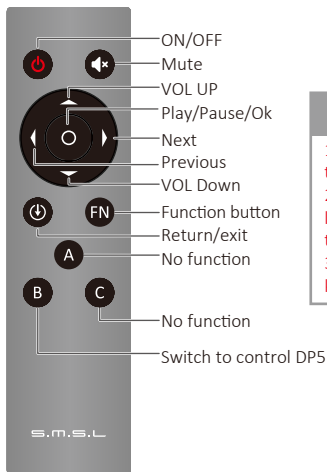

Note

1. Press " B " first , when using DP5 for the first time!
2. In any interface during music playback, long press the function key to return to the " Playing " interface.
3. In any interface, long press the return key to return to the home page.

Use range of remote control

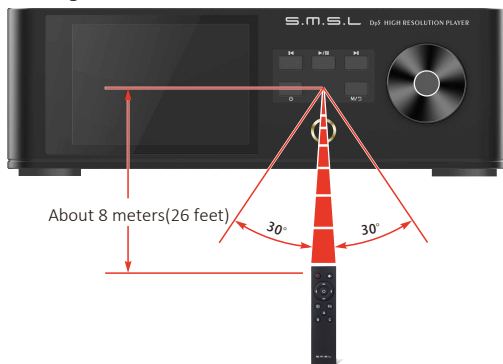

Parts names and functions

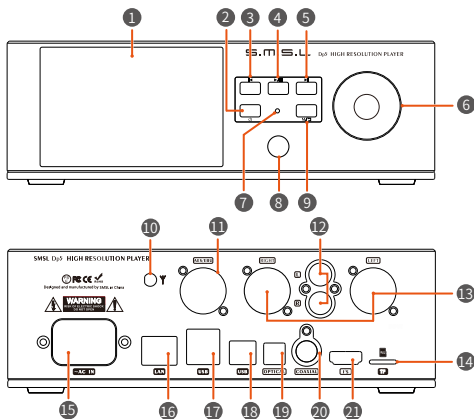

- | | |
|---|-------------------------------------|
| ① Display screen | ⑪ AES output |
| ② Power button, long press ON / OFF, short press turn off display.* | ⑫ Line output |
| ③ "Previous" button, short press the previous song, long press to rewind.** | ⑬ Balance output |
| ④ Play / pause | ⑭ Micro SD card slot |
| ⑤ "Next" button, short press next song, long press fast forward | ⑮ Power AC input |
| ⑥ Knob | ⑯ Network interface |
| ⑦ remote IR window | ⑰ USB 2.0 interface |
| ⑧ Unbalance headset 6.3mm interface | ⑱ USB Audio input |
| ⑨ Return / exit | ⑲ Optical output |
| ⑩ 2.4G/5G dual frequency antenna | ⑳ Coaxial output |
| | ㉑ I ² S output interface |

* Long press for more than 10 seconds in any interface and state to force shutdown.

** Short press, when the current song playing time exceeds 10 seconds, press "Previous Song" to restart playback of the current song. If it does not exceed 10 seconds, play the previous song.

Operation method:

- Multifunction knob: In the playback interface, turn left or right is the volume up or down, short press middle button pause, long press to enter the playback mode menu. Under the menu, rotate left and right to select up and down, short press to confirm.
- Play/pause button: click to play or pause, double click to repeat current track.
- Knob center indicator: red when off, blue when turned on, green when on/off. (The multi-function knob center button has the same function as the remote control confirmation key, and the return key has the same function as the remote control return key.)

Connecting your equipment

Connect headphone and active speakers.

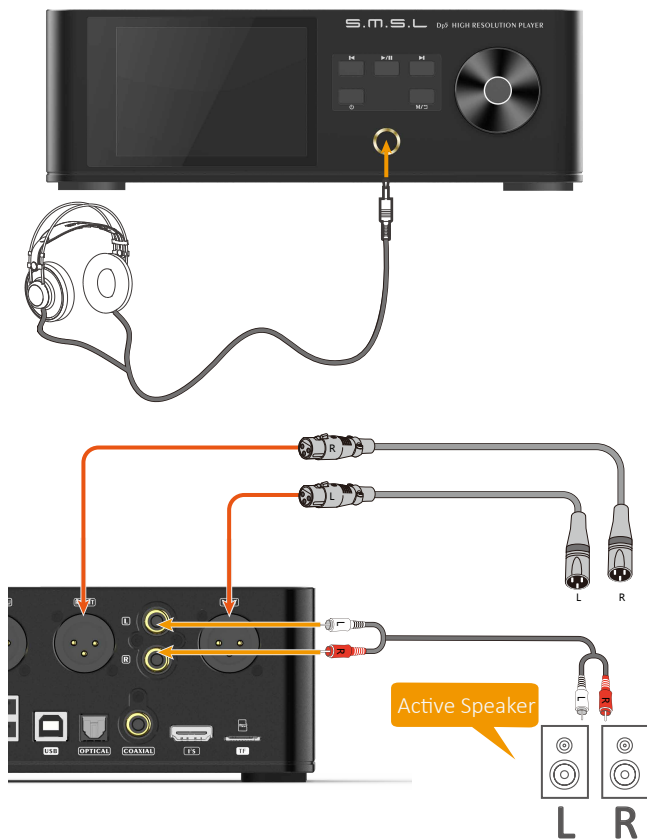

Connecting your equipment

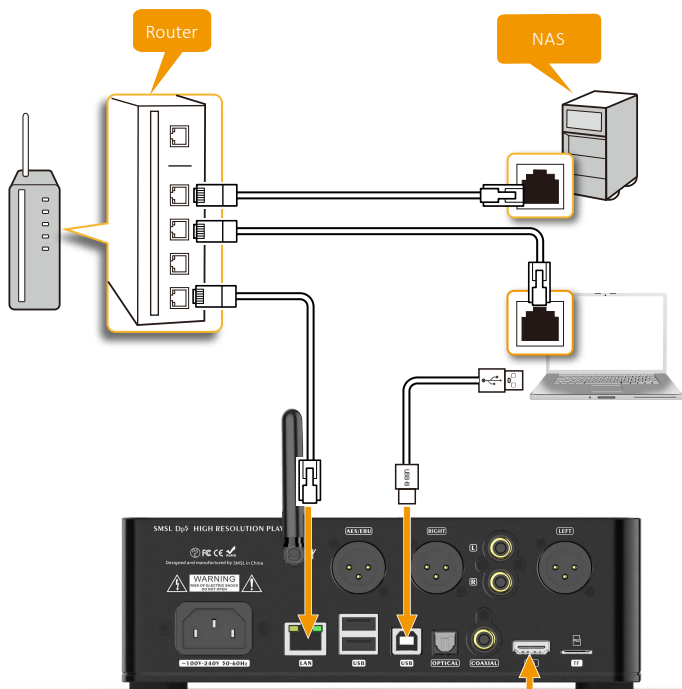

I2S Pins Functions

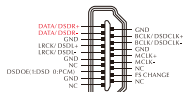

I2S NORMAL

(Figure 1)

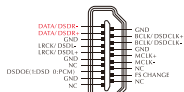

I2S INVERTED

(Figure 2)

Connecting your equipment

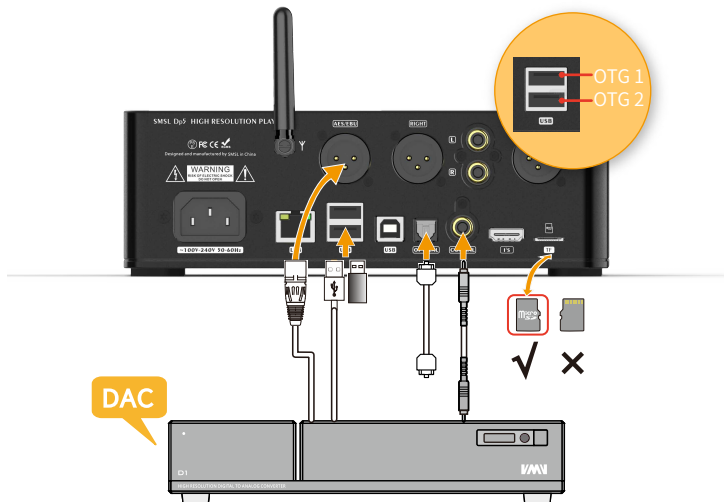

- Instructions for the two USB A ports: 1. When used as a USB hard disk input, the upper interface is OTG_1 and the lower interface is OTG_2.

Note: The sum of the two USB output currents does not exceed 2A.

One of them is used as a USB output. When the USB DAC is connected, the “Audio Device Connection” is displayed, and at the same time, the digital signal is output from this USB interface, and the other output of the DP5 are silent. When unplugged, “Audio Device Disconnect” is displayed, and the original output is restored.

Note: The USB DAC cannot be successfully connected due to USB matching problems.

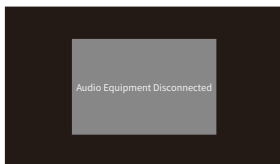
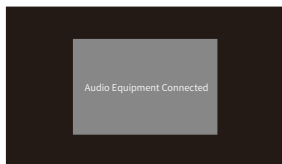

Connecting your equipment

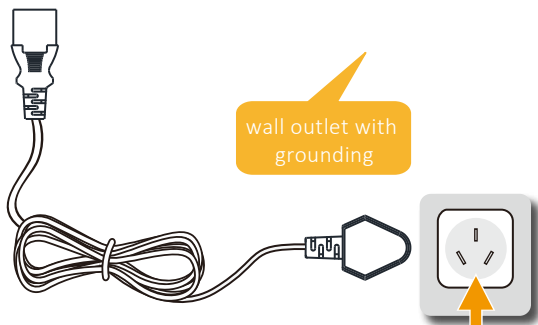

Note: Please use a power outlet with a good grounding wire to ensure safety and avoid noise.

The power state of SD-9 has memory

- Without use the button to shut down, directly unplug the power cord, the next plug will directly boot;
- Hold the knob/remote control power off, the next plug-in will not directly start.

Display

1.Main interface

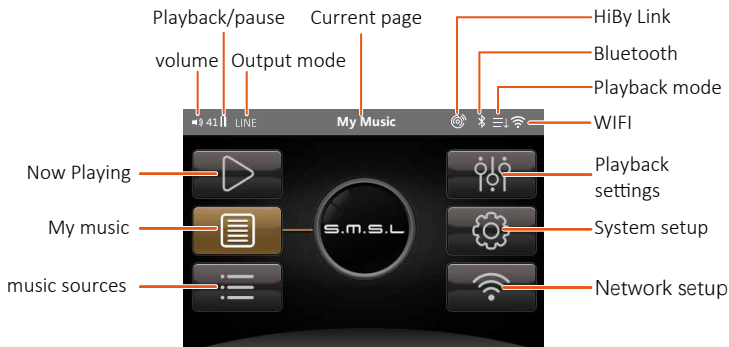

2.Playback interface

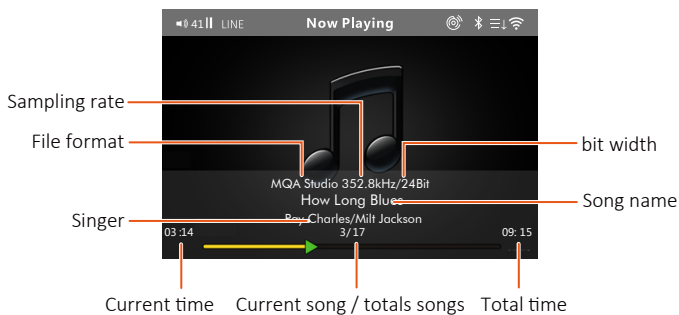

Display

Operation method:

"Multifunction knob":

1. In the playback interface, short press to play or pause, pressing and hold button goes into playback menu.(My favorites, add to song list, delete, list play mode) Short press under the menu to confirm.
2. Turn this knob left or right to turn volume up or down.
3. Play / pause button: click to play or pause; double click to replay current track.

(Note: the "playback / pause key" function is still valid under other menus.)

3. Music library

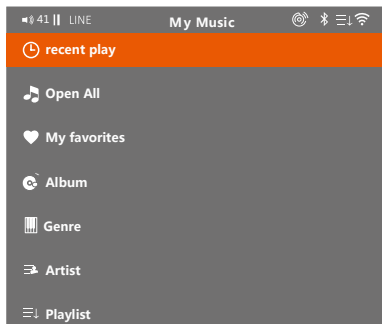

The content of the music library menu is:

- Recent play
- Open all
- My favorites
- Album
- Genre
- Artist
- Song sheet

Operation:

- "Multifunction knob": In playlists, long press knob to delete a song.
- Please pay attention: The maximum number of DP5 song scans is 30,000, and it will not be scanned after exceeding.

(Note: the "function key" of the remote control is the same as the machine "multifunction knob".)

Display

4. File browsing interface

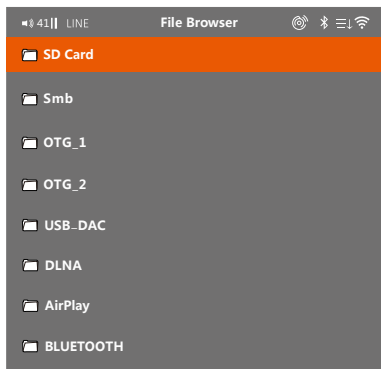

The contents of the file browsing menu are:

1. Micro SD card .
2. LAN.
3. OTG-1.
4. OTG-2.
5. USB-DAC.
6. DLNA
7. AirPlay
8. Bluetooth

Operation:

"Multifunction knob":
long press to Delete files .

5. Playback menu

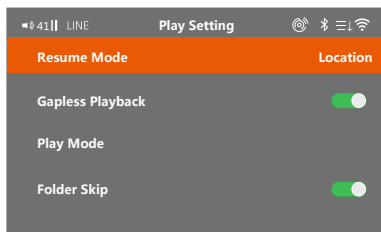

The content of playback menu:

1. Resume Mode:
 - 1.1 "Turn off "next time The last shutdown will not be played The previous repertoire.
 - 1.2 "Repertoire" Memory the track before power off.
 - 1.3 "Position"Memory the position of the track before power off.

2. Gapless playback: Song switching with the same sampling rate does not stop.

3. Play mode: list play, single loop, random play, list cycle.

4. Folder skip: Switching songs is a song that can be jumped to a different file.

(Note: The playback settings are only valid for micro SD cards.)

Display

6.System setting

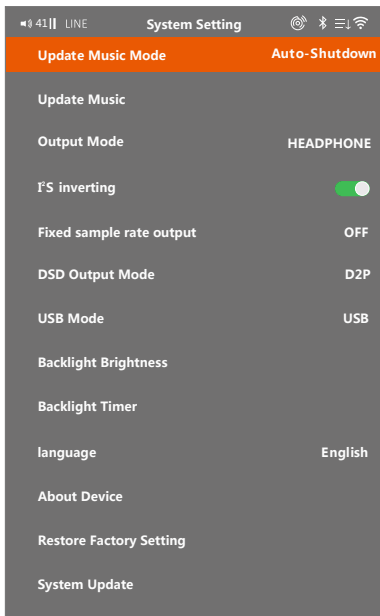

The content of the system settings menu:

1. Update music mode:

- Manual.
- Auto.

(Note: This function only valid by using micro SD card.)

2. Update music: Click start scan memory devices connected to DP5.

3. Output mode:

- headphone output
 - Line output.
- (Digital output is not affected)

4.I²S inverting

Choose or not choose

5.Fixed sample rate output, on or off

- 44100
- 48000
- 88200
- 96000
- 176400
- 192000

6.DSD output mode:

- D2P (DSD to PCM): Converts the DSD signal to a PCM signal output.
- DoP (DSD over PCM): The DSD signal is encapsulated into PCM code for the purpose of transmitting DSD signals (fiber, coaxial, AES transmission DOP signal only supports DSD64).
- DSD Native: Direct DSD data transmission, transmitting DSD encoded digital signals in 1 bit 2.822MHz or multiples thereof.

Display

7.B-type USB mode:

The B-type USB interface is set to “USB mode”. The unit is connected to the computer through the B-type USB interface to access and modify the micro SD card data of the machine. Please pop up before disconnecting.

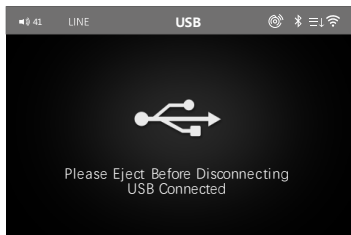

The B-type USB interface is set to “DAC mode”, the B-type USB interface of the unit is the USB Audio input interface, and the machine is used as a normal USB decoding device.



8. Backlight brightness: brightness adjustment is divided into 5 levels.
9. Backlight time: 15 seconds, 30 seconds, 45 seconds, 3 minutes, 5 minutes, 10minutes, never.
- 10.Language: simplified Chinese, Traditional Chinese, English.
- 11.About device: Model External memory Available capacity
Bluetooth address Firmware version
- 12.Restore the factory setting: reset all options set to the machine, restore to the factory setting.
- 13.System upgrade: Download the upgrade firmware to the micro SD card, insert the unit and click the system upgrade.

Display

7. Network setting interface

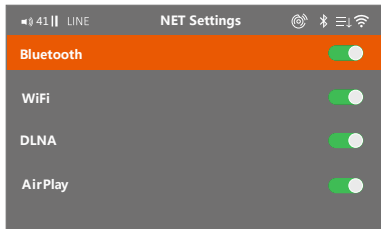

Hiby APP android download:



(Google play)

Operating instructions in the content section of the Network Settings menu:

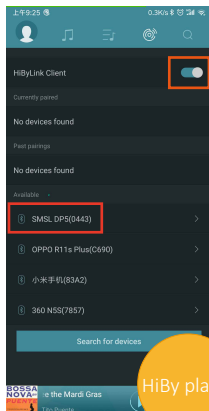
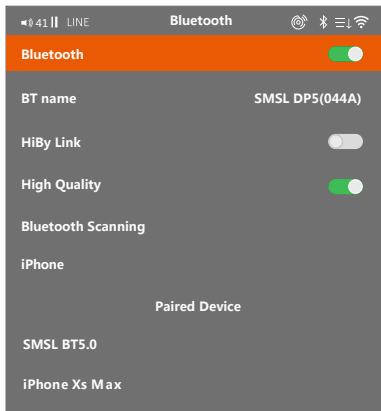

HiBy player

1. Bluetooth

1.1、HiBy Link: The HiBy Link function in the mobile device opens the HiBy player and docks with Dp5. The mobile device can browse the storage device in the unit and can be used as a Bluetooth remote controller.

(Note: When using Bluetooth to input audio, be sure to turn off the HiBy Link of the Dp5.)

Display

1.2、 High sound quality: Using advanced algorithms, the sound quality of Bluetooth transmission is improved.

1.3、 Bluetooth scanning: Scan nearby devices that can connect to Bluetooth, you can choose to connect devices. Select the connected device and press and hold the "Multi-Function Middle Button" to delete the pairing.

2.WiFi: Select "searching Wifi" to scan nearby wireless LAN

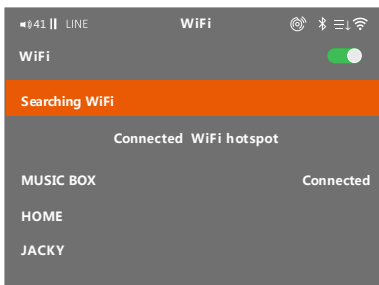

Use the remote control or multi-function knob to enter the password on the virtual keyboard (as shown below, and finally select "OK") to make a paired connection. Show "connected" (as shown above).



Display

SAMBA (NAS) LAN playback:

After the WiFi setting is completed, under the "File Browser" menu, enter the LAN to select the corresponding folder, and read the song for playback. (If the folder is password protected, please cancel it first)

(Note: After switching to different networks, you need to research the server to refresh the file. As the WiFi network is unstable or interfered, it may appear intermittent or even interrupted during playback.)

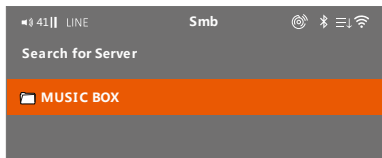
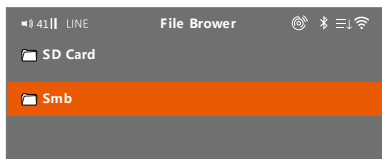

3. DLNA: Dp5 connects to the network, the mobile device installs and opens "Bubble UPnP", plays the song, pull the playback layout to the right, and selects to push to play on "SMSL DP5".

(Note: You can only operate on the same network. As the network maybe unstable, it will cause DLNA playback to be interrupted.)

Display

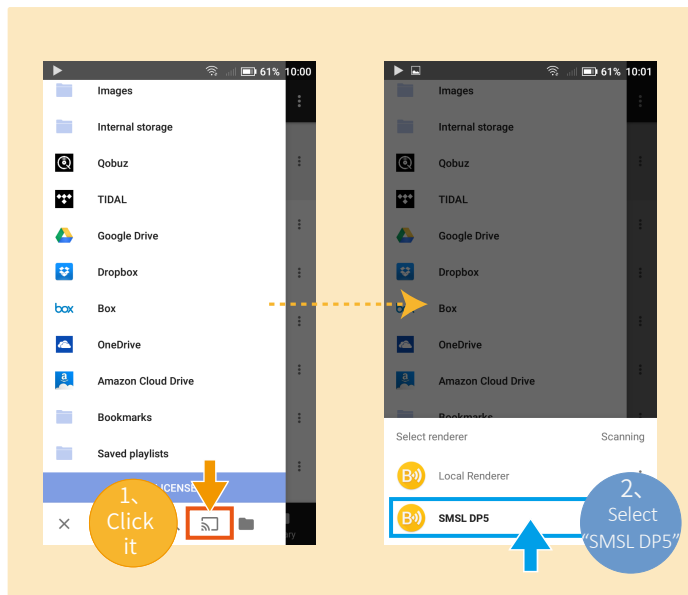

4.AirPlay: As long as the DP5 is connected to the same local area network with your iOS device (iPhone, iPod, iTouch, iPad or iTunes), it will appear in the AirPlay device list. You can simply send the audio stream to DP5 by selecting it.

Please note: Any wireless connection such as Bluetooth or WiFi may be lost or even interrupted due to too far distance or other radio waves. Some Android mobile devices may not be fully compatible with Bluetooth, which

About MQA

MQA (Master Quality Authenticated) is an award-winning British technology that delivers the sound of the original master recording. The master MQA file is fully authenticated and is small enough to stream or download. The DP5 includes MQA technology, which enables you to playback MQA audio files and streams, delivering the sound of the original master recording.

Visit How it works <https://www.mqa.co.uk/how-it-works> for more information.

MQA files playback

- DP5's MQA playback does not require additional software. You can use foobar2000 or Audirvana for MQA playback as it supports ASIO or WASAPI audio output. When playing MQA audio, it is suggested to adjust the volume of the computer to the maximum for the best audio output.
- When playing an MQA file, the sampling rate of the original master recording is displayed.
- MQA files have two file formats: 'MQA' and 'MQA Studio'.
- 'MQA' or 'MQA Studio' indicates that the product is decoding and playing an MQA stream or file, and denotes provenance to ensure that the sound is identical to that of the source material. 'MQA Studio' indicates it is playing an MQA Studio file, which has either been approved in the studio by the artist/producer or has been verified by the copyright owner.

Accessories

- DP5*1
- remote control (1)
- power cord (1)
- USB data line (1)
- antenna (1)
- Instructions (1)
- warranty card (1)
- packing box (1)

Notice

Listening experts advise not to continue to play loud, if you feel discomfort, please reduce the volume or stop using it.

Warranty terms

1.The Term of Service

Foshan Shuangmusanlin Technology Co., Ltd promises to offer good-quality products. If the product is broken in 7 days after purchasing when you use it normally, you can choose to send it back for return, replacement or repairing (only the product does not affect the second sales can be returned). Repairing for free in one year if you use it normally.

2.Date of purchase is in accordance with the date on invoice or receipt issued by seller, and if you buy it online, you can show the screenshot of trade.

3.If an inappropriate usage causes the unit damaged, the warranty will be void. As below.

- a.All damages by inappropriate use, including using it under non-normal working environment or without following the instructions.
- b.Dismantling, refitting, repairing by user in private.
- c.Causing damage by using some fittings instead of the designative or accredited ones.
- d.Cannot provide credible proof of purchase.
- e.Products not from S.M.S.L(e.g. counterfeits).

4.Sending it back to our company for repairing.

5.Contact your S.M.S.L Audio reseller for a Return or replacement.

Foshan Shuangmusanlin Technology Co., Ltd.

Address: Rm302, 32th Building, Zhifu Industrial Park, Erhuan Rd,
Xingtian, Shunde, Foshan, Guangdong, CN

Tel: +86-757-27789994

<http://www.smsl-audio.com/>