

26 mm Dome Tweeter

D2604/830000

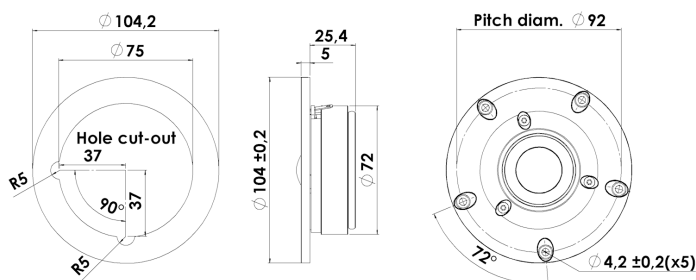

T-S Parameters:

Resonance frequency [fs]	630 Hz
Mechanical Q factor [Qms]	3.46
Electrical Q factor [Qes]	1.02
Total Q factor [Qts]	0.79
Force factor [Bl]	2.2 Tm
Mechanical resistance [Rms]	0.48 kg/s
Moving mass [Mms]	0.42 g
Compliance [Cms]	0.15 mm/N
Effective diaph. diameter [D]	32 mm
Effective piston area [Sd]	8 cm ²
Equivalent volume [Vas]	0.01 l
Sensitivity (2,83V/1m)	92 dB

Mechanical Data:

Voice coil diameter	26 mm
Voice coil height	2 mm
Voice coil layers	2
Gap height	2.5 mm
Linear excursion	± 0.3 mm
Max mech. excursion	± 1.6 mm
Unit weight	0.5 kg
Cabinet Displacement Volume	0.10 l

Electrical Data:

Nominal impedance [Zn]	4 Ω
Minimum impedance [Zmin]	3.7 Ω
Maximum impedance [Zo]	12.3 Ω
DC resistance [Re]	2.8 Ω
Voice coil inductance [Le]	0.04 mH

Power Handling:

100h RMS noise test (IEC 18.4)	100 W
Long-term max power (IEC 18.2)	240 W
X-over: 2. order HP Butterworth, 2.5 kHz	

Key Features:

- High sensitivity - 92dB
- Extended Frequency to Above 30KHz
- Low Resonance Frequency - 630Hz
- Low Distortion
- Wide Dispersion
- Textile Diaphragm, Wide Surround

Recommendations (please see Tech Note):

- Operating frequency range: 2500-20000 Hz
- Cabinet volume - closed box: N.a.
- Cabinet volume - vented box: N.a.

