



**PU400-2CH
KIT**

EN

Assembly Instructions

TABLE OF CONTENTS

Chapter	Page
Introduction	3
Tools / Parts	4
User Instructions	9
Safety precautions	11
Assembly	12
System information	22
Warranty & Support	23

INTRODUCTION

- SoundImpress DIY Stereo Kit • 2 x 425W • Eigentakt • Powered by [Purifi](#) •

The Eigentaktimplementation from Purifi is one the best amplifier technologies available. This class D technology meets high standards and gives super performance an any playback level, regardless of load. The [EVAL1](#) stands among the top of our amplifier module technology. This assembly instruction covers the general assembly instructions for this specific model. For detailed technical information about the used modules please refer to the datasheet on our website.



RECOMMENDED TOOLS

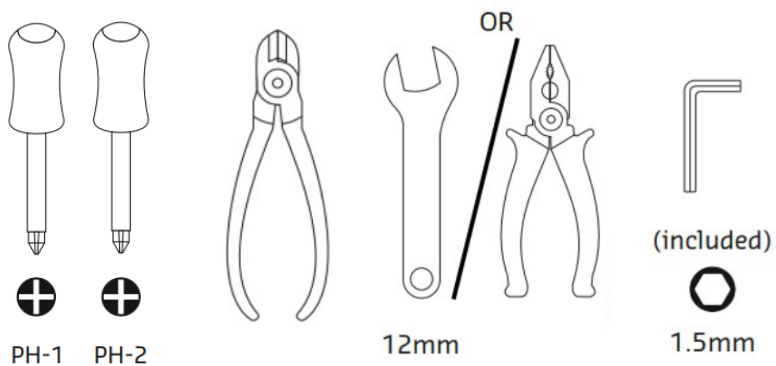

Recommended tools are not included, unless otherwise indicated

PARTS

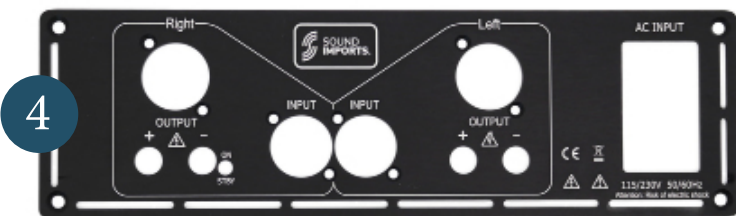
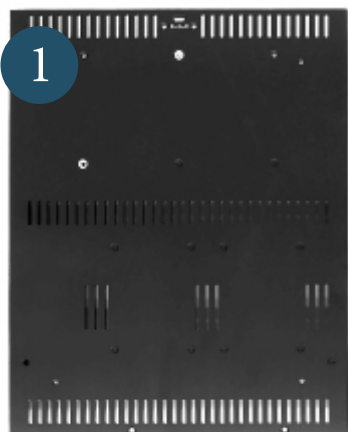

5



6



7



9



8



10



11



12

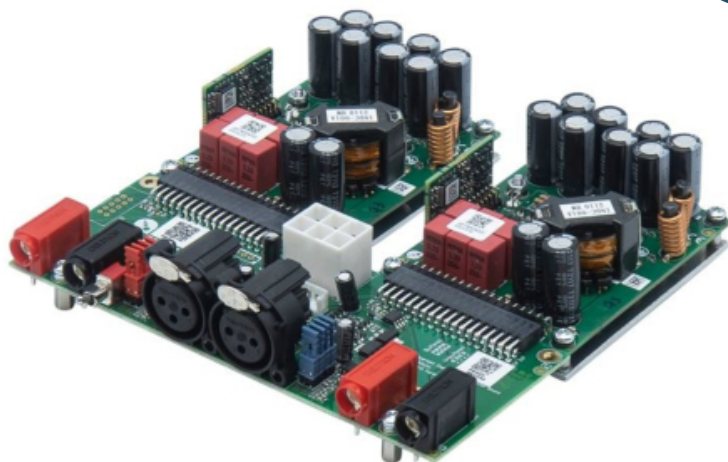

Part number	Description
1	Bottom plate
2	Top cover plate
3	Front panel (with LED)
4	Back panel
5	Cable set ¹
6	Neutrik connection
7	IEC
8	Feet
9	Frontplate braces
10	LED module
11	SMPS1200A400
12	EVAL 1

¹ Cable set includes the following cables:

1x power cable between [SMPS1200A400](#) & Purifi [EVAL1](#)

1x AUX power cable between SMPS1200A400 & Purifi EVAL1

1x LED cable from SMPS1200A400 to LED module

1x AC Power Cable from IEC input to SMPS1200A400

1x Connection cable for IEC input

1x Mains jumper from SMPS1200A400 (connected = 115V, not connected = 230V)

USER INSTRUCTIONS

- LED Switch

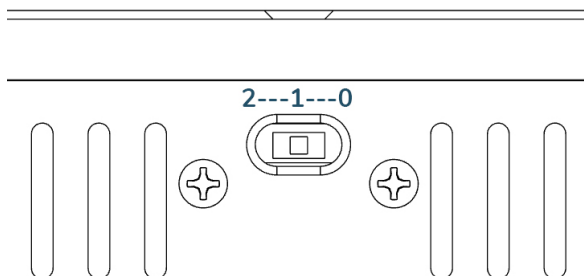

- 0 --- LED OFF
1 --- Normal brightness
2 --- Max brightness

- **Jumper configuration**

SMPS1200A400 is by default configured for regulated Vaux. This must be changed to unregulated via jumpers J6 and J7.

Position 2-3: Unregulated VAUX

If the PSU is configured incorrectly the EVAL1 will not function properly!

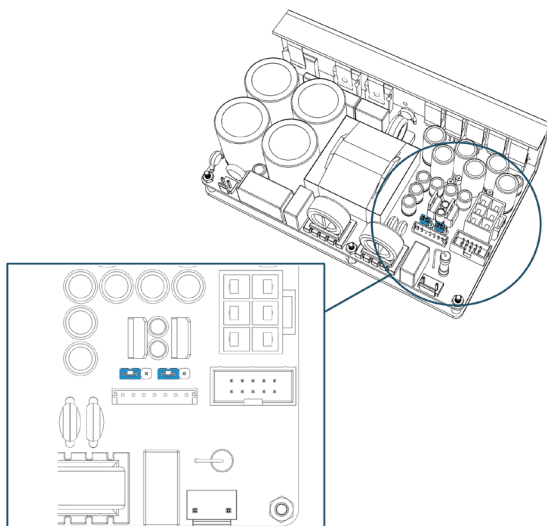

For the full application note – connecting EVAL1 to SMPS1200A400, follow [this link](#).

SAFETY PRECAUTIONS

This unit operates at mains voltage and carries dangerous voltages at accessible parts. These parts may never be exposed to unintended touch. Observe extreme care during installation and never touch module of the unit while it is connected to the mains. Disconnect the unit from the mains and allow all capacitors to discharge for 10 minutes before handling it. Damage due to inappropriate handling is not covered by warranty. This product has no user-serviceable parts.

- Read these instructions and heed all warnings.
- Do not use this apparatus near water.
- Clean only with a dry cloth.
- Natural convection should not be impeded by covering the module (apart from the end applications housing). Do not block any ventilation openings.
- Do not defeat the safety purpose of the protective earth / grounding mains inlet.
- Protect the power cord from being walked on or pinched particularly at plugs, convenience receptacles, and the point where they exit from the apparatus.
- Only use attachments/accessories specified by the manufacturer.
- This apparatus shall not be exposed to dripping or splashing, and no object filled with liquids, such as vases or glasses, shall be placed on the apparatus.
- Do not overload wall outlets and extension cords as this can result in a risk of fire or electric shock.
- This apparatus has been designed with Class-I construction and must be connected to a mains socket outlet with a protective earthing connection.
- Do not run any cables across the top or the bottom of the module. Apply fixtures to cables to ensure that this is not compromised.
- Before using this product, ensure all cables are correctly connected and the power cables are not damaged.
- Service or modifications by any person or persons other than by SoundImports authorized personnel voids the warranty.



Attention: Observe precautions for handling electrostatic sensitive devices. This module uses semiconductors that can be damaged by electrostatic discharge (ESD).



Dangerous voltage within the product's enclosure, that may be of significant magnitude to constitute a risk of electric shock to persons.



Sharp edges. Watch your fingers.

ASSEMBLY

- IEC socket wiring

1 Connect AC neutral

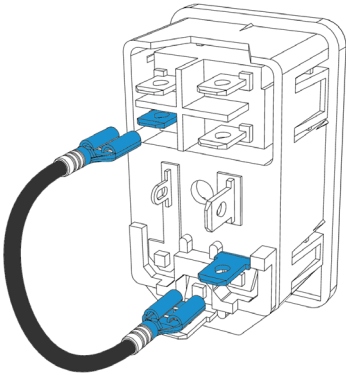

2 Connect AC hot

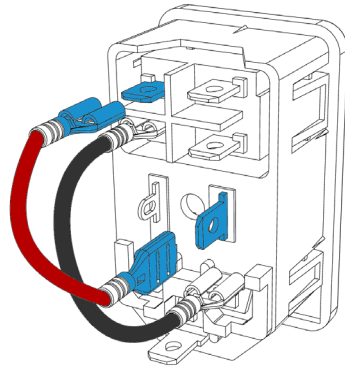

3 Connect AC out

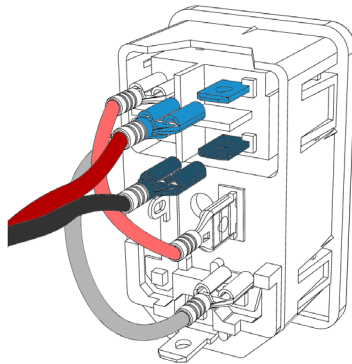

- **Insert IEC socket into backpanel**

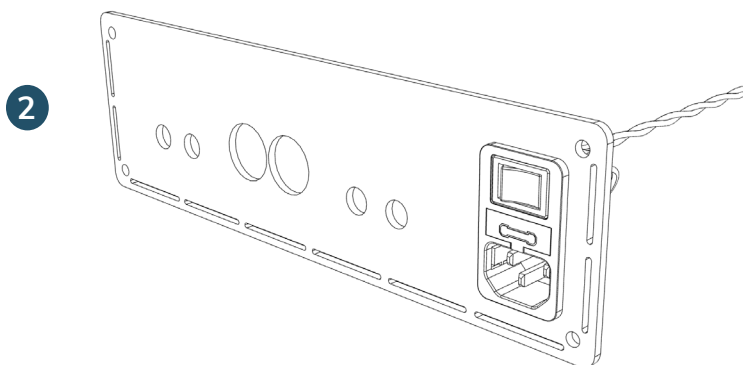
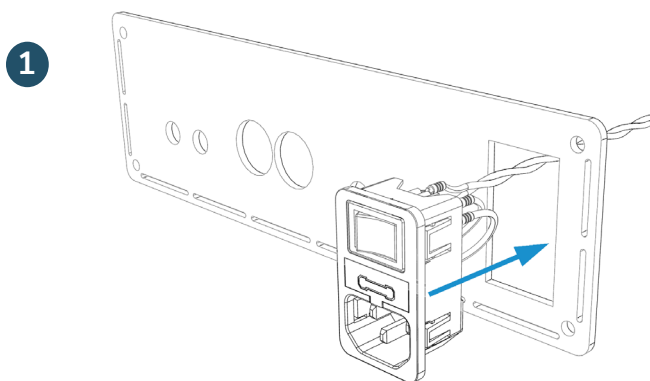

- **Place the power supply**

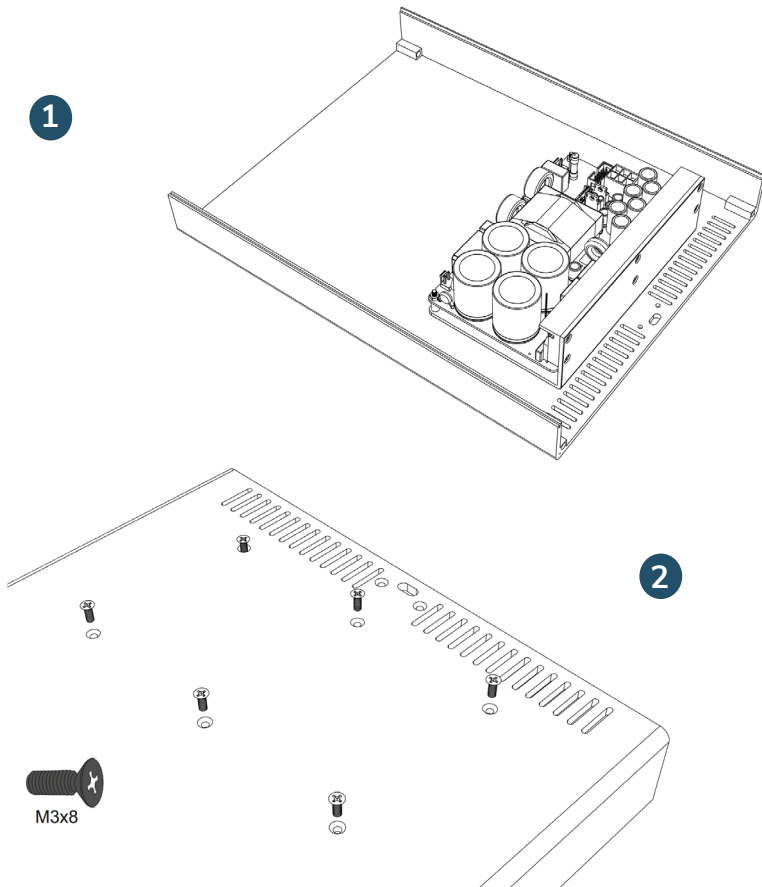

- **Attach rear panel**

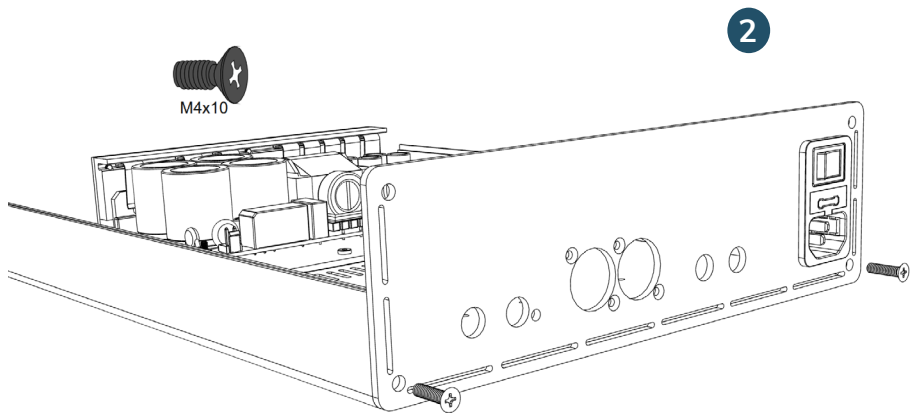
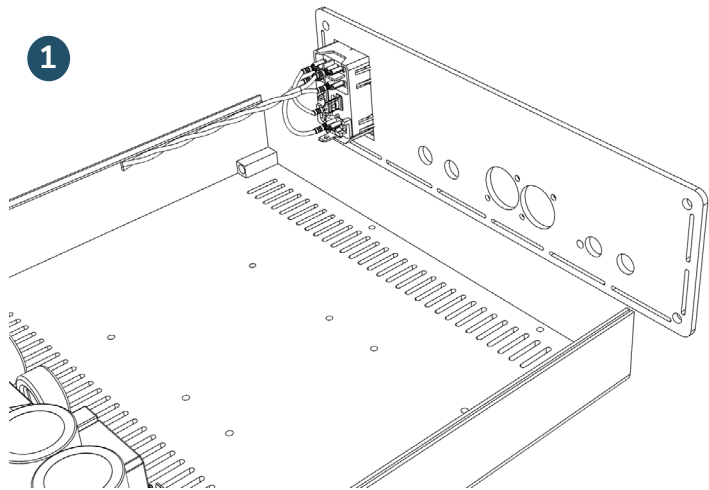

- **Place amp module**

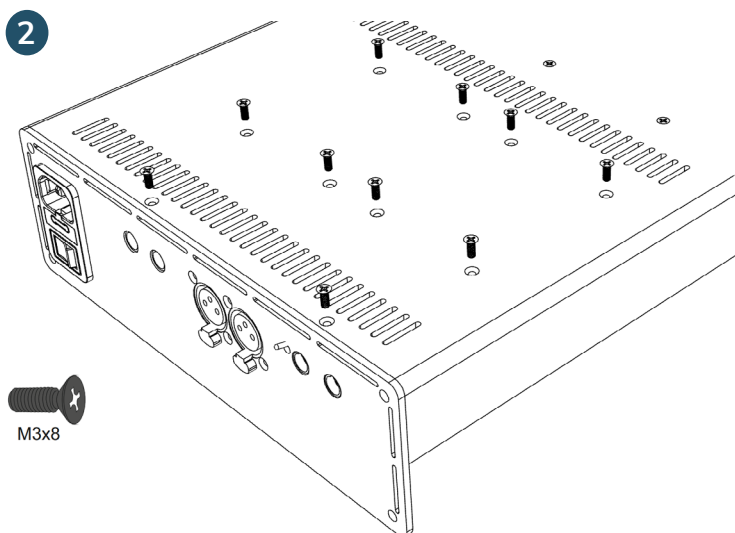
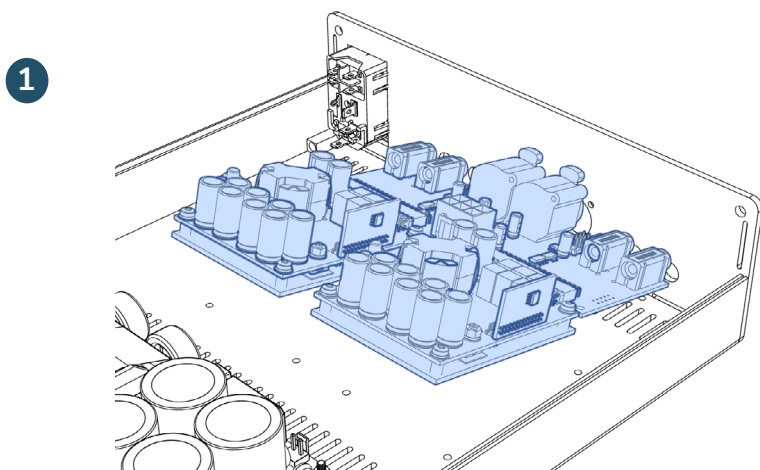

- **Screw amp module on rear panel**

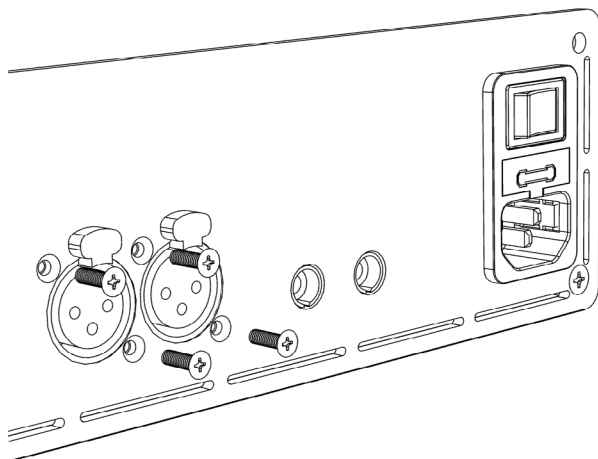

- **Place top cover plate**

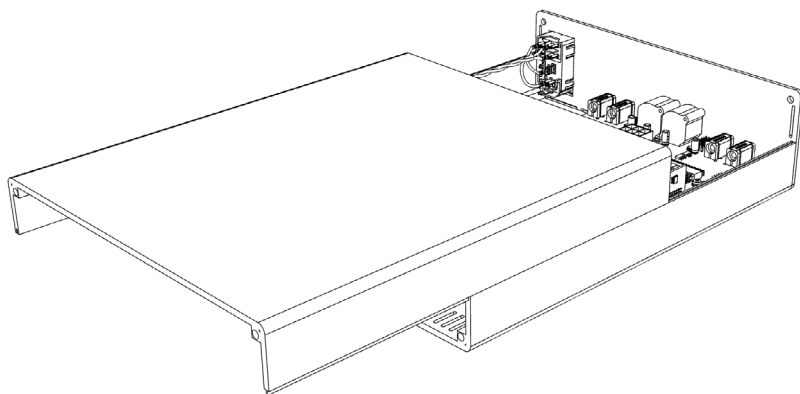

- **Screw top cover plate (rear)**

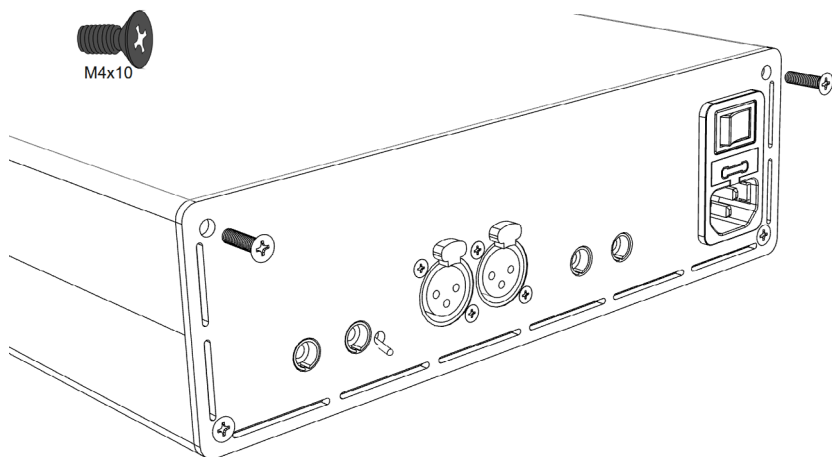

- **Attach front plates**

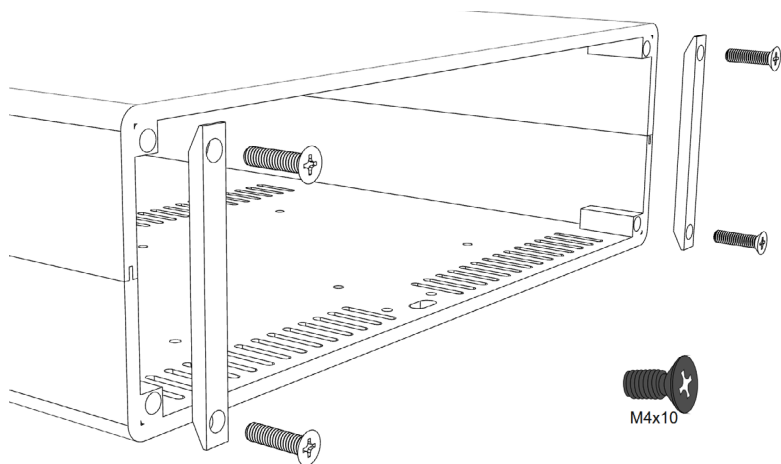

- Place front panel



M3x5

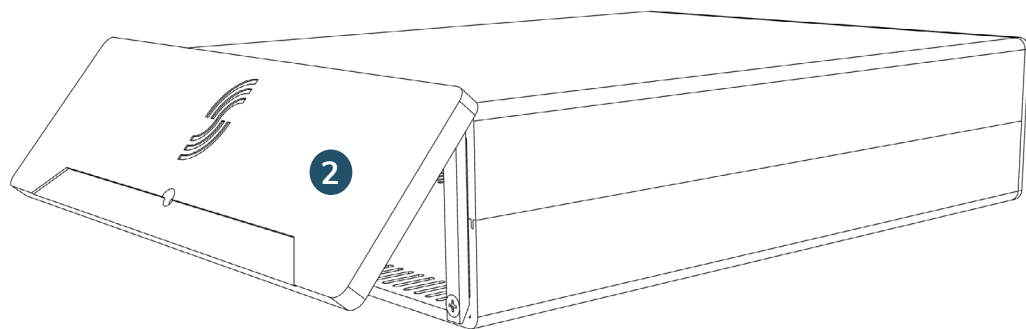

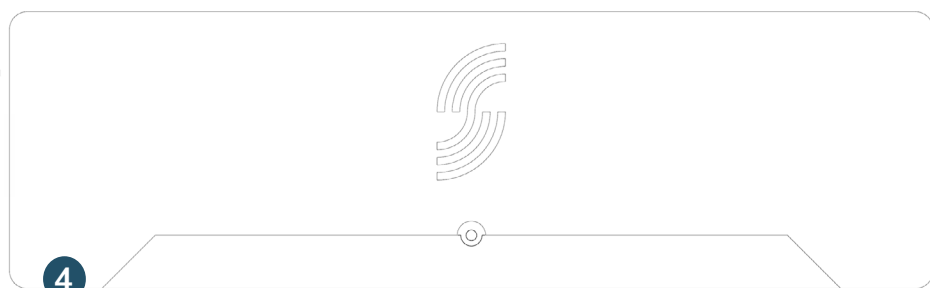
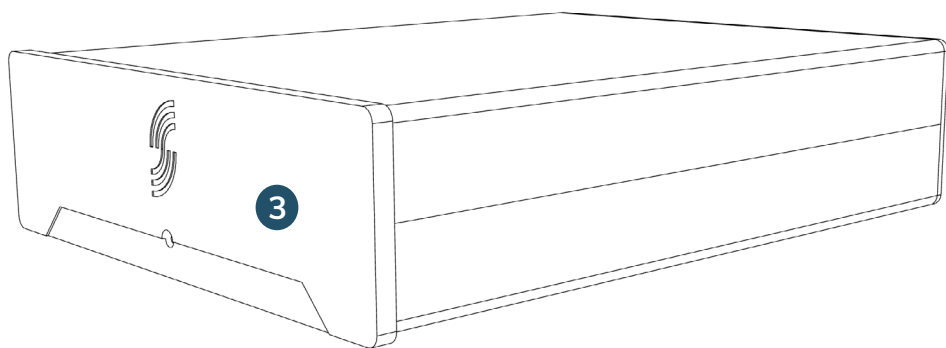

HAVE FUN LISTENING



**SOUND
IMPRESS.**

SYSTEM INFORMATION

Rated power output (RMS)	425 watts at 4 ohms 227 watts at 8 ohms 450 watts at 2 ohms
Minimum load	2 ohms
Signal-to-noise ratio (SNR)	131 dB
Distortion	0.00017 % THD+N at 20-20,000 Hz, 4 ohms, 100 watts
Efficiency	> 94%
Frequency response	0 - 60,000 Hz
Input impedance	4.4k ohms (14 dB) / 10.2k ohms (27 dB)
Circuit Topology	Eigentakt
Amplifier classification	Class D
Speaker output channels	2
Input connection type	XLR
Speaker output connection type	Banana
Power requirements	110 / 230 VAC (symmetric supply +/-)
Power inlet connector	IEC C14
Dimensions (D x W x H)	260 x 78 x 325 mm
Case material	Aluminum

WARRANTY & SUPPORT

LIMITED WARRANTY - SoundImports warrants this device for a period of five years after the original date of purchase against defects due to faulty workmanship or materials arising from normal use of the device. The warranty covers working parts that affect the function of the device. It does NOT cover cosmetic deterioration caused by fair wear and tear, or damage caused by accident, misuse or neglect. Any attempt to modify or take apart the device (or its accessories) will void the warranty.

If you discover a defect, notify SoundImports during the warranty period. Claims under warranty must be supported by reasonable evidence that the date of the claim is within the warranty period. To validate your warranty, please keep your original purchase receipt together with these warranty conditions for the duration of the warranty period. Replacement products claimed under warranty are not entitled to renewed 5-year warranty coverage.

SUPPORT - We are continuously working to enhance your experience with our products. If you have any comments, remarks or have found a defect, please contact us. If you have any problems with your amplifier please check this assembly manual. If this manual is not sufficient to troubleshoot your problem contact SoundImports support department. The latest datasheets and manuals can be found on our website. If you can't find the answer there, you can also contact us and we will be happy to help!



**SOUND
IMPRESS.**



PURIFI

SoundImports

Peizerweg 97a

9727AJ Groningen

Netherlands, the

Tel: +3185-0711860

Email: info@soundimports.nl

VAT identification number: NL861325254B01

Chamber of Commerce number: 78268753